

## Standard Pad Handle



### Code

4032  
4034  
4035

### Finish

Satin Anodised Aluminium  
Satin Stainless Steel  
Polished Stainless Steel

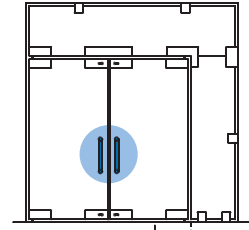
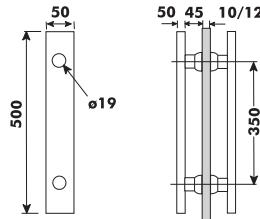

## 19115 D Type Handle



Hole diameter 16-18mm  
Hole centres 360mm

### Code for the complete item

19115 SAA

Satin Anodised Aluminium

Picture for representation only.  
Actual handle may differ.

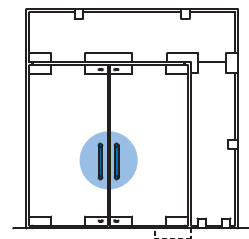
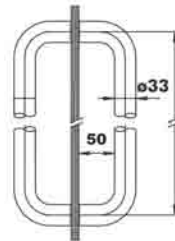

## 19115 D Type Handle



Hole diameter 14-16mm  
Hole centres 350mm

### Code for the complete item

19115 SSS

Satin Stainless Steel

19115 PSS

Polished Stainless Steel

Picture for representation only.  
Actual handle may differ.

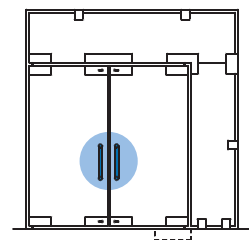
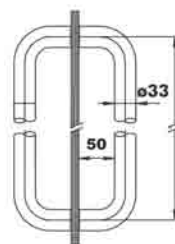

## 19123 E Type Handle



Sizes o/all	hole cent'
600mm	450mm
1200mm	1050mm
1800mm	1650mm
hole diam	12mm

### Code for the complete item

19123 SAA

Satin Anodised Aluminium

19123 SSS

Satin Stainless Steel

19123 PSS

Polished Stainless Steel

Picture for representation only.  
Actual handle may differ.

33mm Dia

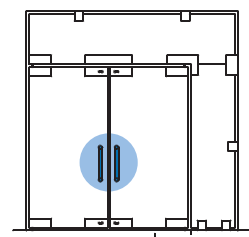

# Pull Handles

## 19116 Cranked D Type Handle

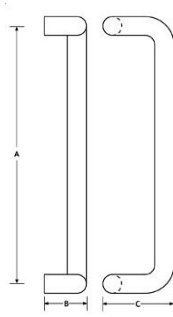

### Code for the complete item

19116 SAA	Satin Anodised Aluminium
19116 SSS	Satin Stainless Steel
19116 PSS	Polished Stainless Steel

Picture for representation only. Actual handle may differ.

## 19117 Cranked C Type Handle

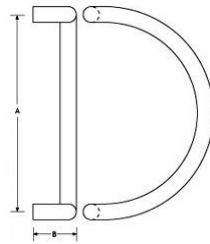

### Code for the complete item

19117 SAA	Satin Anodised Aluminium
19117 SSS	Satin Stainless Steel
19117 PSS	Polished Stainless Steel

Picture for representation only. Actual handle may differ.

## D Handle 19mm

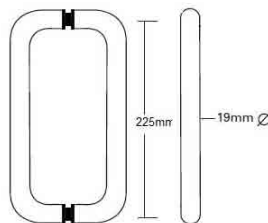

### Code for the complete item

- D Handle 19mm Diameter Duo
- D Handle 19mm Diameter SSS
- D Handle 19mm Diameter PSS

14mm Diameter Hole in glass

## Elbaine Door Handle



### Code

4-230

### Finish

Satin Stainless Steel

Overall height

450mm

Hole Centres

300mm

Hole dia

20mm





# Sliding Door Handles

## Shell Handle 70mm Dia

**Code**  
4-121

**Finish**  
SSS

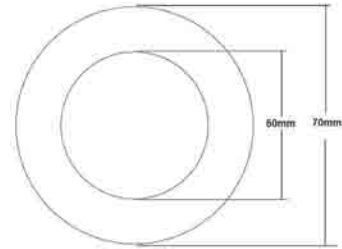

## B93 Handle for Sliding Door

**Code for the complete item**

B93 ISS  
B93 SAA

Imitation Stainless Steel Finish  
Satin Anodised Aluminium Finish

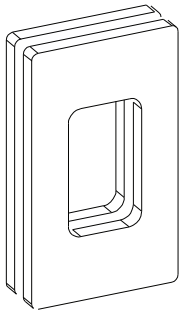

16mm Dia Holes

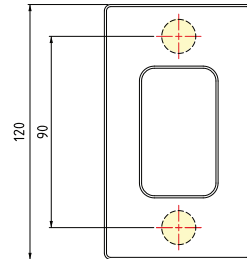

## 5B01 Handle for Sliding Door

**Code for the complete item**

5B01 ISS  
5B01 SAA

Imitation Stainless Steel Finish  
Satin Anodised Aluminium Finish

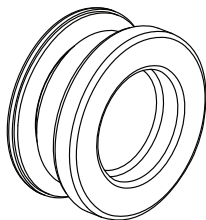

34mm Dia Hole

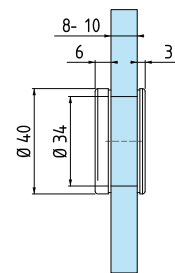

## 5BN0 Handle for Sliding Door

**Code for the complete item**

5B0 ISS  
5B0 SAA

Imitation Stainless Steel Finish  
Satin Anodised Aluminium Finish

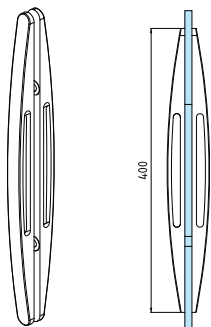

14mm Dia Holes, 200mm Centres

